

## Jurassic Park Inspired Cross Stitch



Difficulty Level: ★★☆☆☆ to ★★★★★

### Your kit

Cross stitch fabric (Aida)  
Tapestry Needle  
Black & Yellow thread (2 strands thick)  
Extra single strand thread in black and white (Optional detail for level 3)

You'll also need a pair of scissors  
Plus, a 6x4" frame & masking tape, if you would like to frame your design.

### Stitching the Pattern

Each Square on the grid represents a single cross stitch, stitch one cross in the relevant colour.

Start stitching in the middle of the design, to make sure it is centred on the fabric and you won't run out of space, and work outwards.

\*Cheat tip\* use a piece of chalk to mark the centre and edges of the design to follow, as chalk will wipe off later.

Continue stitching from section to section, or letter to letter, taking the thread across the back between each (8).

You only need to stop and start a new piece of thread when you are about to run out.

Once the design is complete secure the threads together at the back by tying together using double knots, and then trim any excess lengths.

### How to Cross Stitch

#### Sewing Basics

Stitch with 2 strands thickness, as thicker becomes difficult to stitch.

I have separated the strands for you, but if you purchase new embroidery floss, it is usually 6 threads thick and you would need to separate the strands.

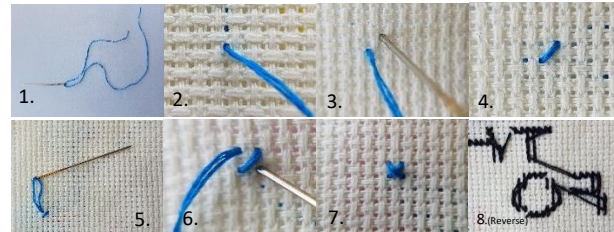

Thread the needle and tie a double knot at the longest end (1). If you are struggling to thread, cut the ends to give a sharper finish, and dampened with a tiny bit of water.

Cross stitch fabric (Aida) is created with larger gaps evenly placed in between the warp and weave (horizontal and diagonal) threads; you'll be sewing by putting the needle through those larger gaps.

Start at the back of the fabric and, put the needle through a larger gap (2).

Take the needle to the opposite corner of the square on the fabric and put the needle down through the larger gap in the fabric (3), creating one arm of a cross (4). You want to pull enough that the thread lays even on the fabric; but do not pull so tight that you distort the shape of the fabric.

Follow the line of the fabric to the next large gap and come up through the fabric (5) take the needle to the opposite corner and go down through the larger gap in the fabric (6). This should have created a cross, an X (7).

Continue to stitch crosses where needed following the pattern provided.

When you get to the end of a thread length, leave it hanging it at the back of the design and remove the needle.

Start your next bit of thread as before, close to where you last finished, and after completing you first cross, tie the new thread with the old thread in a double knot at the back of the design to secure the two.

### Options

This design has different levels, you can choose how much you want to stitch.

#### *Level 1: Text only*

Follow the sewing basics to complete the text 'Life Finds a Way' in black, and yellow box surround.

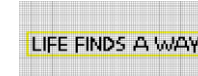

#### *Level 2: Text + Dinosaur*

Continue the design the add the yellow circle surround and black dinosaur shape.



#### *Level 3: Text + Dinosaur + Detail lines*

With the single thread, add the extra black lines around the dinosaur to add spines and arms.

With the white thread stitch over the top of the centre of the letters.

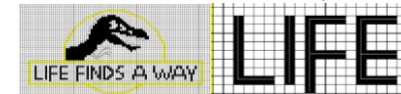

### Framing the Design



This cross stitch is designed to fit a standard 4x6" (approx. 15x10cm) frame.

Take the frame apart and centre the card inner on the back of the finished design. Fold over the edges and secure with tape as taught as you can, then put inside the frame to display.

